

# [1002] ALLIANCE SUBFLOOR CONSTRUCTION - CONNOR® SPORTS

## 1. INSPECTION AND PREPARATION OF THE SUBFLOOR

Refer to the Gerflor document entitled «Preparing the subfloor for installing Connor sports floor coverings».

## 2. MATERIALS

**NOTE :** before you start work, check with our technical services whether this data sheet has been amended by a more recent version. Examine the materials prior to installation to ensure that there are no visual defects. If the flooring has already been installed, the cost of any remedial work will not be covered.

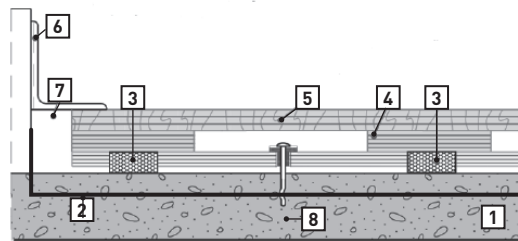
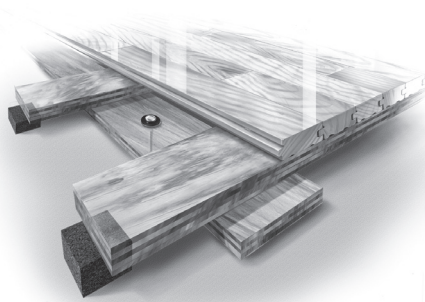

### DESCRIPTION

1. Concrete slab
2. Polyethylene (0.15 mm)
3. Resilient pads (50 x 50 x 20 cm)
4. Preassembled subfloor construction
5. Flooring
6. Vented cove base (76 mm x 102 mm)
7. Expansion space (38 mm)
8. Screws

## 3. SUBFLOOR CONSTRUCTION AND TOOLS

MATERIALS SUPPLIED WITH THE ORDER BY GERFLOR	MATERIALS AVAILABLE ON ORDER FROM GERFLOR	MATERIALS AND TOOLS SUPPLIED BY THE INSTALLER
FOR THE SUBFLOOR CONSTRUCTION		
		Staples 32 mm / 5,000 units / 1 box (900 m <sup>2</sup> )
Preassembled subfloor construction / 1 panel = 3.34 m <sup>2</sup> (spacing included)		Circular saw / jigsaw
	Vented cove base (1.22 linear metres) / 16 units	Electric screwdriver
Polyethylene 0.15 mm / 1 box (185.7 m <sup>2</sup> ) + Adhesive tape		Hammer drill
Anchor pins (three parts) / length 64 mm / diameter 6 mm / 8 per panel / 1 box (186 m <sup>2</sup> )		Drill bit (6 mm)
Spacer wedge / thickness 6 mm (stop wedge)		Staple gun
		Hammer
		Adhesive sealant

## 4. CONDITIONS AND PREPARATION OF THE GYMNASIUM

### ■ 4.1 - STORAGE

The materials required to install the ALLIANCE subfloor construction must be stored on site, in a dry area of the gymnasium that is protected from variations in temperature.

### ■ 4.2 - ACCLIMATISATION PERIOD

**IMPORTANT :** three days prior to installation, the ambient temperature in the room must be between 15 and 30°C. Relative humidity must be between 30 and 60%. Once these conditions are met, all protective coverings and packaging can be removed to allow the materials to acclimatise. After unpacking, the materials must be left to rest for three days before installing.

While installing the subfloor construction, maintain the same conditions (i.e. ambient temperature from 15 to 30°C and relative humidity between 30 and 60%). If there is any moisture in the room (such as a new build), you are advised to ventilate the room for four to six weeks before installing the subfloor construction. Ensure that the room is ventilated throughout installation.

# SPORTS FLOORS

## [1002] ALLIANCE SUBFLOOR CONSTRUCTION - CONNOR® SPORTS

### 5. LAYING THE POLYETHYLENE VAPOUR BARRIER

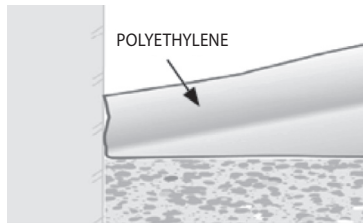

A polyethylene vapour barrier with a thickness of 150 microns must be laid across the entire subfloor with an overlap of at least 15 cm.

The overlap is bonded using single-sided moisture-resistant adhesive tape. The vapour barrier is turned up at the edges of the room and laps up to the finished floor level.

### 6. INSTALLING THE SUBFLOOR CONSTRUCTION

■ Cross-cut a starter panel into two equal halves (refer to the diagram).

Fix the blocks beneath the cut section.

Use the left section ① to start the first row at the far end of the gymnasium.

Maintain a space of 38 mm between the subfloor construction and all the walls and vertical obstructions.

#### TIPS

Support sleeper ends with solid blocking material to simplify assembly of the subfloor construction elements ④

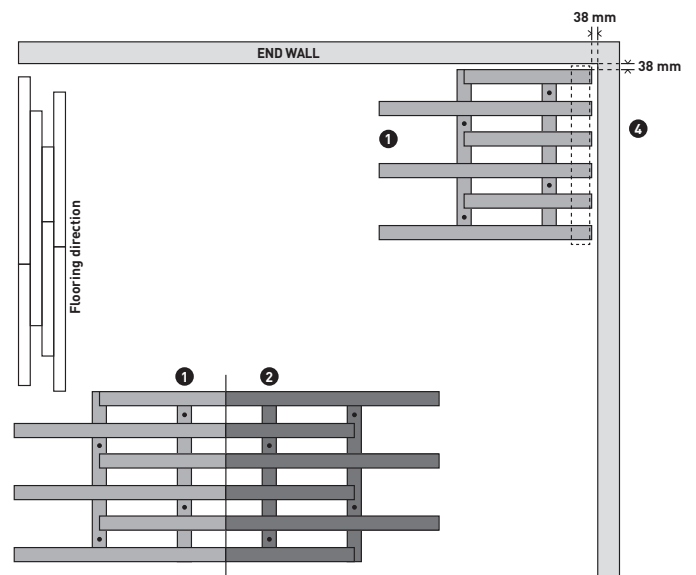

■ Continue the first row with full panels ③ and finish by trimming the last panel to fit the dimensions of the gymnasium.

Fix the subfloor construction elements together and maintain a space of 6 mm between the ends of the sleepers.

Elements must be fixed together using adhesive and 32 mm staples.

Anchor the subfloor construction as you go along; refer to Section 8, entitled «Anchoring the subfloor construction».

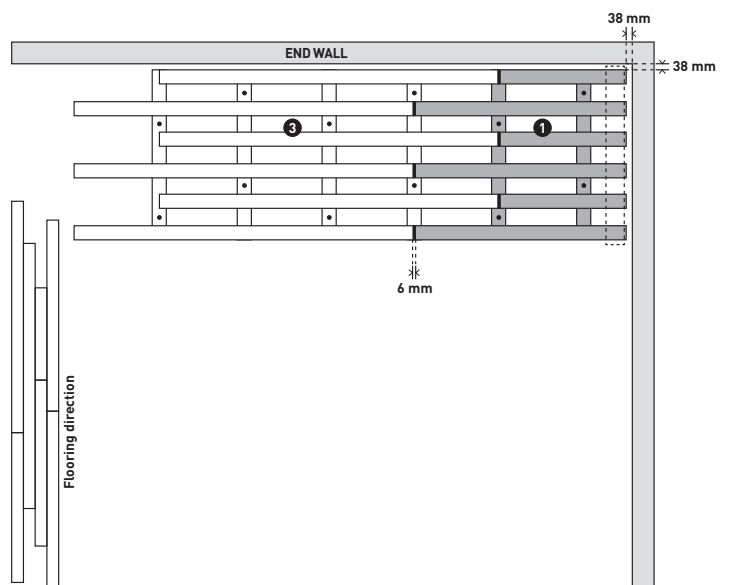

# [1002] ALLIANCE SUBFLOOR CONSTRUCTION - CONNOR® SPORTS

■ Start the second row by rotating the right end **2** of the cross-cut panel before installing.

Provide the same spacing between each row as provided between the sleepers, **i.e. 121 mm**.

Continue the second row with full panels and finish by trimming the last panel to fit the dimensions of the gymnasium.

Anchor the subfloor construction: refer to Section 8, entitled «Anchoring the subfloor construction».

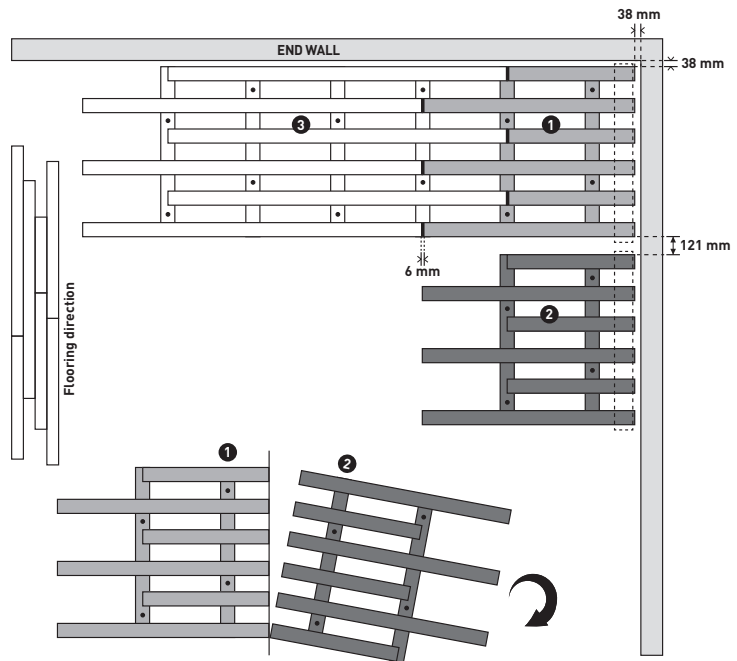

■ Continue installing rows in the same manner by cross-cutting a starter panel each time.

Maintain a space of 6 mm between each element of the subfloor construction.

Glue and staple the elements together and anchor to the ground as specified in Section 8.

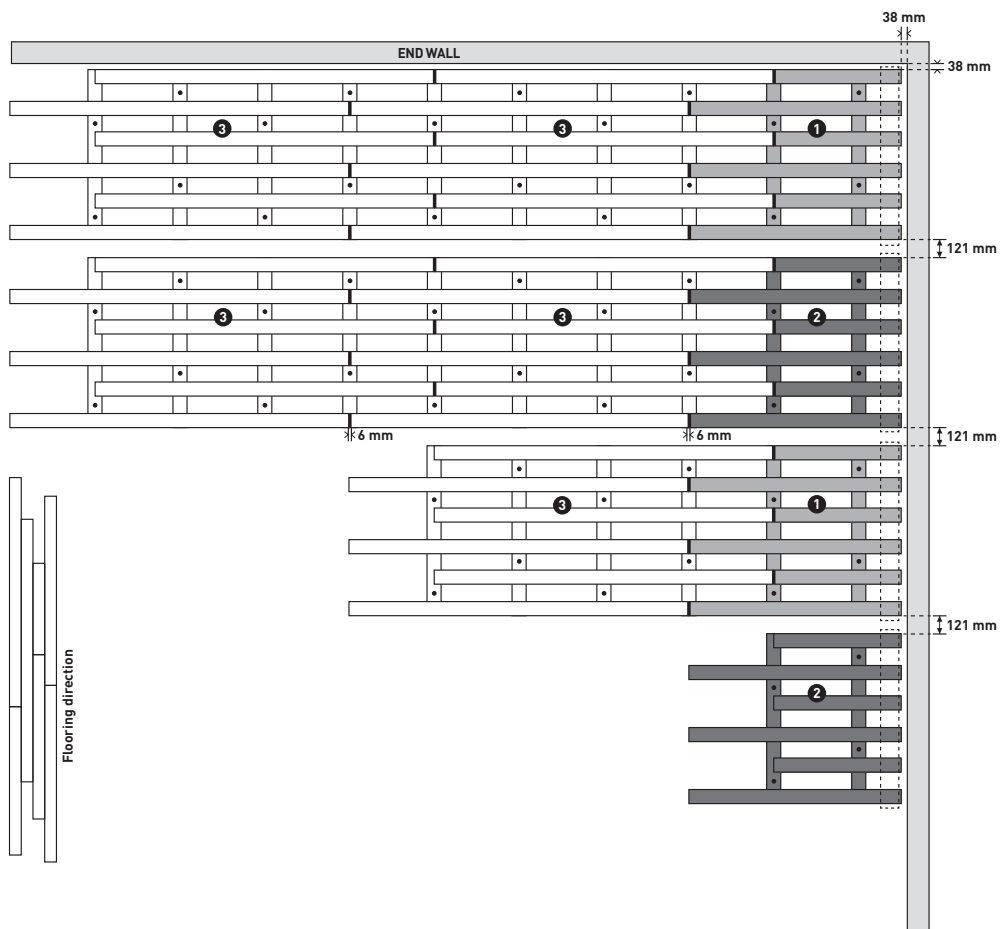

# SPORTS FLOORS

## [1002] ALLIANCE SUBFLOOR CONSTRUCTION - CONNOR® SPORTS

### 7. SOLID BLOCKING TO BE INSTALLED BENEATH RETRACTABLE SEATING SYSTEMS IN THE STACKED POSITION, IN FRONT OF ACCESS DOORS, STORAGE AREAS, PORTABLE BASKETBALL STANDS, ETC.

Solid blocking must be installed instead of pads in areas subject to high static loads. Remove the pads and screw the blocks into the subfloor construction.

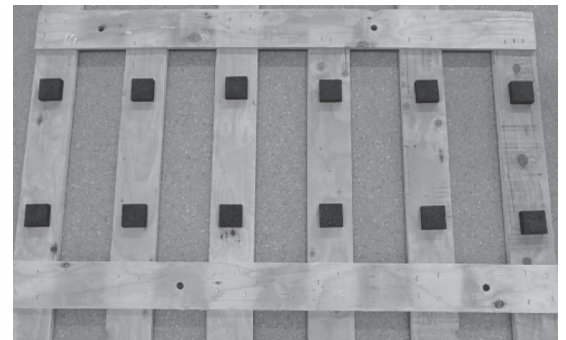
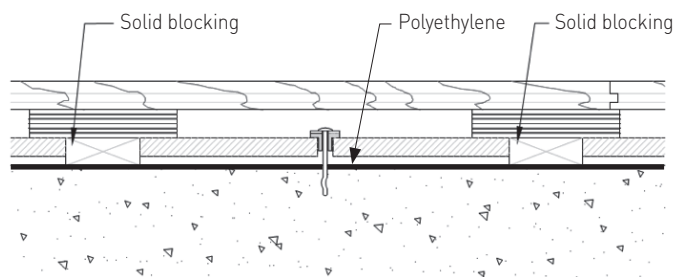
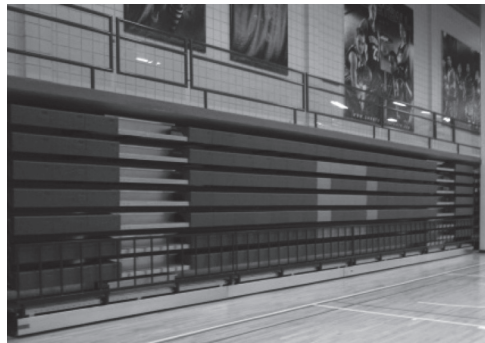

1. Remove the pads.
2. Replace with wooden blocks measuring 50 x 50 mm x 20 mm (thickness).

### 8. ANCHORING THE SUBFLOOR CONSTRUCTION

#### 8.1 - DRILLING FOR THE ANCHOR PINS

Use a hammer drill and a 6 mm masonry drill bit. Drill through the pilot holes in the subfloor construction and the polyethylene. Drill depth through the subfloor construction = 70 mm

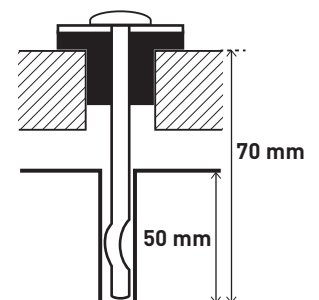

#### 8.2 - FIXING THE ANCHOR PINS

##### 8.2.1 Preparing the anchor pins

Anchor pins are supplied in three parts. Place the washer with the rubber side up against the underside of the anchor pin head. This prevents the two metal parts from coming into contact and causing squeaking over time.



1 - Anchor pin

2 - Washer to be fitted with the rubber side up

3 - Rubber bushing with the widest part facing up

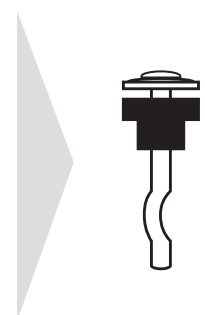

# [1002] ALLIANCE SUBFLOOR CONSTRUCTION - CONNOR® SPORTS

## 8.2.2 Installing the anchor pins

Before hammering the pin through the subfloor construction, place the spacer wedge between the sleeper and the polyethylene to avoid driving the subfloor in too far.

The spacer wedge offsets the difference in thickness and allows the pad to perform its cushioning role



Place this wedge beneath the sleeper before hammering the anchor pin.



Hammer the pin into place.

## 9. INSTALLING THE FLOORING

Refer to the document on installing flooring.

## 10. SANDING AND SEALING CONNOR FLOORING

Refer to the Gerflor document on sanding and sealing CONNOR flooring.

## 11. GAME LINE PAINTING

Refer to the document on TLD Aqua game line painting.